

PORT INFORMATION AND VESSEL ACCEPTANCE CRITERIA

Installation: Solventaş Teknik Depolama A.Ş.
IMO Port facility number / ISPS Statement number: TRIZT-0023 / 0941008
Address: Dilovası Organize Sanayi Bölgesi 1. Kısım Tuna Cad. No: 7 Dilovası 41455 Kocaeli/TÜRKİYE
Phone: +90 262 648 27 00 / 40 / 41 / 42 Fax: +90 0262 648 27 95
E-mail: gemi@solventas.com.tr

BERTH INFORMATION

Jetty No: No:1 Jetty	Jetty No: No:2 Jetty
Location-Coordinates: 40° 46.003' N- 29° 32.654' E	Location-Coordinates: 40° 46.048'N, 29° 32.376' E
Direction of Jetty: 172,1°	Direction of Jetty: 157,6°
Length of Jetty: 270 m	Length of Jetty: 235 m
Breadth of Jetty: 10 m	Breadth of Jetty: 10 m

Berthing maneuver alongside East&West side of jetties: Vessel/Pilot preference

Water Density: 1,0170 kg/cm ³ - @20 °C	Min. Under Keel Clearance: 0,5 m
Max. Vessel Length Overall (LOA): Nr.1:200m, Nr.2:180m	Max allowable speed of impact at the jetty: 0,10 m/s
Max. Vessel Beam Allowed: 35 m	Max allowable angle of impact at the jetty:
Max. Draft Allowed: 12 m for Nr.1 Jetty, 10 m for Nr.2 Jetty	Barges: 15°
Max. Air Draft Allowed: No restriction	Vessels <10.000 DWT: 10°
Max. DWT Allowed: 50.000 DWT	Vessels = 10.000-50.000 DWT: 8°

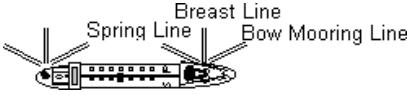

* Mooring-Spring and Breast line on bow and stern must be double.

WIND LIMITS AT JETTY

Max. Wind speed to stop operations : 6 at Beaufort scale (22-27 knot)
Max. Wind speed to disconnect hoses : 7 at Beaufort scale (28-33 knot)
Max. Wind speed for unberthing : 8 at Beaufort scale (34-40 knot)

*Wind direction at jetty is from Sector of SE/S/SW 0 – 2 on Beaufort scale

*Tidal range at jetties are in the range of -5, +100 cm.

REMINDERS

1. Cargo Owners to provide a valid Q88 form prior to fixing of vessels.
2. Vessels manifold outlet/s should have a compatible design with Solventaş flanges of hoses in DIN2576 (EN1092-1) Standards mentioned below:

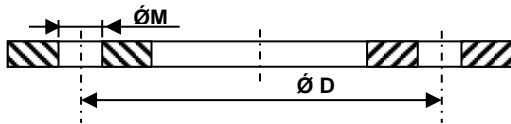

PN 16	Ø D -Bolt Circle Diameter (mm)	Ø M -Bolt Hole Diameter (mm)	Bolt Number
DN 200	295	22	12
DN 150	240	22	8
DN 100	180	18	8

RESTRICTIONS

1. The use of portable pumps are prohibited.
2. Berthing is not allowed after sunset. Unberthing at night is allowed.
3. Vessels over 25 years of age are restricted from berthing at Solventaş jetties.
4. Vessels are required to be double hulled.
5. A positive means of segregation method must be employed between the cargo tanks and lines.
6. Storing and bunkering activities are prohibited.
7. Solventaş does not provide access equipment. Vessels with more than 4 meter of freeboard must provide their own accommodation ladder.

IMPORTANT CONTACTS

Fire Brigade : 110	Hospital : + 90 262 644 1460
Ambulance : 112	Custom Enforcement : 136
Police : 155	Coast Guard : 158
Environmental Office: 181	Pilot Office (Dekaş) : + 90 262 745 38 16
Red Crescent : 168	Weather Forecast https://www.mgm.gov.tr/eng/marine-24hours.aspx